

Forged Steel Globe Valve

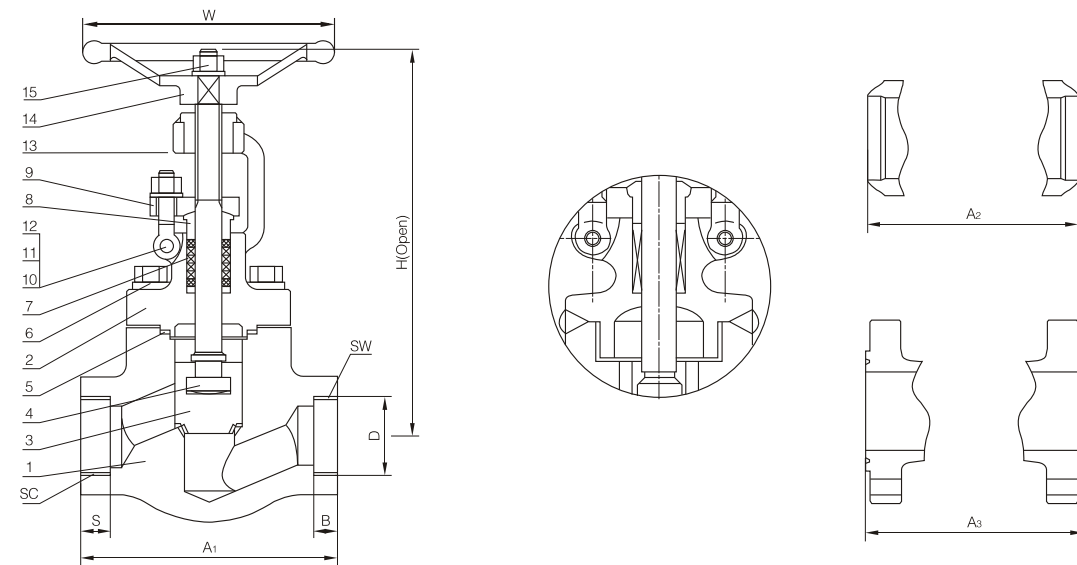

Technical Specification

Steel Globe Valves, API 602
 Steel Valves, ASME B16.34
 Face to Face, Manufacturer Standard
 Face to Face, Flanged, ASME B16.10
 End Flanges, ASME B16.5
 Buttwelding Ends, ASME B16.25
 Socket-welding Ends, ASME B16.11
 Screwed Ends, ASME B1.20.1
 Inspection and Test, API 598

Design Description

Outside Screw and Yoke (OS&Y)
 Bolted Bonnet
 Choice of WB, Welding Bonnet
 Seat Rings Integral with Body
 Yoke Integral with Bonnet
 Rising Stem and Handwheel
 Horizontal Service
 SW, Socket-welding Ends
 SC, Screwed Ends
 BW, Buttwelding Ends

Form of Major Part Material

No.	Part Name	ASTM Material							
		Carbon Steel	F11	F22	304 Type	316 Type	304L Type	316L Type	20 Alloy
1	Body	A105	A182 F11	A182 F22	A182 F304	A182 F316	A182 F304L	A182 F316L	20-Alloy
2	Bonnet	A105	A182 F11	A182 F22	A182 F304	A182 F316	A182 F304L	A182 F316L	20-Alloy
3	Disc	A182 F6a	A182 F11+HF	A182 F22+HF	A182 F304	A182 F316	A182 F304L	A182 F316L	20-Alloy
4	Stem	A182 F6a	A182 F11	A182 F22	A182 F304	A182 F316	A182 F304L	A182 F316L	20-Alloy
5	Bonnet Gasket	304+Graphit	304+Graphit	304+Graphit	304+Graphit	316+Graphit	304L+Graphit	316L+Graphit	316+Graphit
6	Bonnet Bolt	A193 B7	A193 B7	A193 B16	A193 B8	A193 B8	A193 B8	A193 B8	A193 B8
7	Packing	Graphite	Graphite	Graphite	Graphite *2	Graphite *2	Graphite *2	Graphite *2	Graphite *2
8	Gland	A276 410	A276 410	A276 410	A276 304	A276 316	A276 304L	A276 316L	20-Alloy
9	Gland Flange	A182 F6a	A182 F11	A182 F22	A182 F304	A182 F304	A182 F304	A182 F304	A182 F304
10	Eyebolt	Carbon Steel	A193 B7	A193 B7	A193 B8	A193 B8	A193 B8	A193 B8	A193 B8
11	Eyebolt Nut	Carbon Steel	A194 2H	A194 2H	A194 8	A194 8	A194 8	A194 8	A194 8
12	Eyebolt Pin	A276 410	A276 410	A276 410	A276 304	A276 304	A276 304	A276 304	A276 304
13	Yoke Sleeve	Bronze	Bronze *3	Bronze *3	Bronze	Bronze	Bronze	Bronze	Bronze
14	Hand wheel	Malleable iron	Malleable iron	Malleable iron	Malleable iron	Malleable iron	Malleable iron	Malleable iron	Malleable iron
15	Wheel Nut	Carbon Steel	Carbon Steel	Carbon Steel	Stainless Steel	Stainless Steel	Stainless Steel	Stainless Steel	Stainless Steel
*1	PN ≥ 600 Class seal face will be HF								
*2	PTFE Optional								
*3	Ductile Ni-Resist iron Optional								
Na	Integral with vessel								

Forged Steel Globe Valve

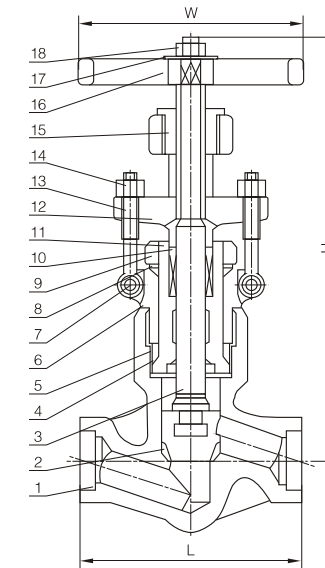

Technical Specification

Steel Globe Valves, API 602
 Steel Valves, ASME B16.34
 Face to Face, Manufacturer Standard
 Face to Face, ASME B16.10
 Buttwelding Ends, ASME B16.25
 Socket-welding Ends, ASME B16.11
 Screwed Ends, ASME B1.20.1
 Inspection and Test, API 598

Design Description

Outside Screw and Yoke (OS&Y)
 Pressure Seal Bonnet
 Choice of WB, Welding Bonnet
 Single wedge, Fully Guided
 Renewable Seat Rings
 Yoke Integral with Bonnet
 Rising Stem and Handwheel
 SW, Socket-welding Ends
 SC, Screwed Ends
 BW, Buttwelding Ends

Form of Major Part Material

No.	Part Name	CS to ASTM	AS to ASTM	SS to ASTM	
		Type A 105N	Type F22	Type F304(L)	Type F316(L)
1	Body	A105N	A182 F22	A182 F304(L)	A182 F316(L)
2	Disc	A276 420+STL	A276 304+STL	A276 304(L)+STL	A276 316(L)+STL
3	Stem	A276-410	A182 F22	A182 F304(L)	A182 F316(L)
4	Seal Place	A105	A182 F22	A182 F304(L)	A182 F316(L)
5	Packing Ring	A182 F304	A182 F304	A182 F304(L)	F316(L)
6	Bonnet	A105N	A182 F22	A182 F304(L)	A182 F316(L)
7	Pin	A276 420	A276 420	A182 F304	A182 F304
8	Gasket	A105N	A182 F22	A182 F304(L)	A182 F316(L)
9	Promotes the Nut	A194 2H	A194 4	A194 8	A194 8M
10	Stem Packing	Flexible graphite+304	Flexible graphite+304	Flexible graphite+316	Flexible graphite+316
11	Gland	A276 420	A276 420	A182 F304	A182 F304
12	Gland Flange	A105	A105	A182 F304	A182 F304
13	Gland Eyebolt	A193 B7	A193 B16	A193 B8	A193 B8M
14	Gland Nut	A194 2H	A194 4	A194 8	A194 8M
15	Yoke Nut	A276 420	A276 420	A276 420	A276 420
16	Hand Wheel	A197	A194 4	A197	A197
17	Nameplate	SS	SS	SS	SS
18	Stem Nut	C.S	C.S	SS	SS

Forged Steel Globe Valve

Class900 ~ 1500 Main Outline Dimensions & Weight

Bold fastening valve cover(RJ), reduced port, outside screw stem & yoke (OS&Y).
The terminal connection or receives for the thread inserts welds, designs according to BS5.352

F.P	1/2	3/4	1	1 1/4	2	2 1/2
L	110	110	150	150	210	235
W	110	110	130	210	180	250
H	227	227	300	307	40	448
d	9	12	15	20	32	40
Weight(kg)	5	5	10	11.5	22	37

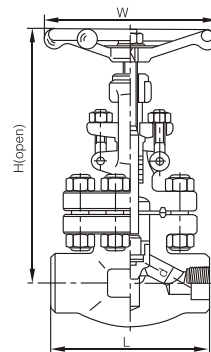

Class900 ~ 1500 Main Outline Dimensions & Weight

Pressure seal bonnet, reduced port, outside screw stem & yoke (OS&Y).BS 5352

F.P	1/2	3/4	1	1 1/4	1 1/2	2
L	140	140	140	178	178	216
W	200	200	200	280	280	300
H	320	320	320	440	440	490
d	12	15	20	28	32	40
Weight(kg)	11.5	10.8	10.5	19.6	21.1	55.4

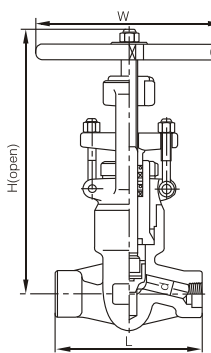

Class2500 Main Outline Dimensions & Weight

Bold fastening valve cover(RJ), full port (OS&Y).
The terminal connection for receives inserts welds, designs according to ASME B16.34

F.P	1/2	3/4	1	1 1/2	2
L	150	150	210	235	235
W	130	130	250	300	300
H	293	300	390	435	435
d	11	14	19	28	35
Weight(kg)	10	10.3	22.4	38	38

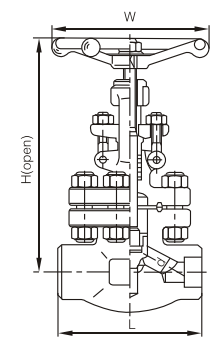

Class2500 Main Outline Dimensions & Weight

Reduced port (OS&Y).
The terminal connection for receives inserts welds, designs according to ASME B16.34

F.P	1/2	3/4	1	1 1/4	1 1/2	2
L	186	186	186	232	232	279
W	200	200	200	280	280	300
H	375	378	380	490	490	540
d	11	14	19	25	28	35
Weight(kg)	12.3	11.6	10.8	26.0	28.4	60

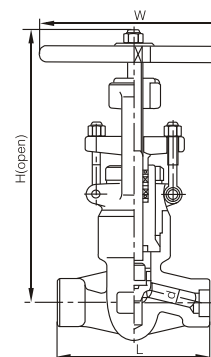

Forged Steel Globe Valve

Class800 Main Outline Dimensions & Weight

Bold fastening valve cover, outside screw stem & yoke (OS&Y).
designs according to BS5,352.

R.P	-	1/2	3/4	1	1 1/4	1 1/2	2	2 1/2
F.P	1/4	3/8	1/2	3/4	1	1 1/4	1 1/2	2
L	79	79	92	111	120	152	172	200
W	100	100	100	125	160	160	180	200
H	164	164	164	203	224	260	300	355
d	7	9	13	17.5	23	30	35	46
Weight(kg)	1.9	2.28	2.37	4.3	5.75	7.8	12.5	17.5

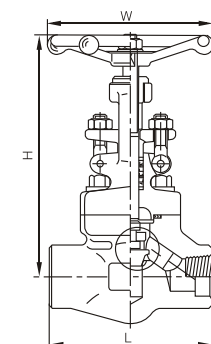

Class800 Main Outline Dimensions & Weight

Weld joint valve cover, outside screw stem & yoke (OS&Y).
Designs according to BS5,352.

R.P	-	1/2	3/4	1	1 1/4	1 1/2	2	2 1/2
F.P	1/4	3/8	1/2	3/4	1	1 1/4	1 1/2	2
L	79	79	92	111	120	152	172	200
W	100	100	100	125	160	160	180	200
H	164	164	164	203	224	260	300	355
d	7	9	13	17.5	23	30	35	46
Weight(kg)	1.7	1.7	1.9	3.3	5.2	6.8	10.6	13.8

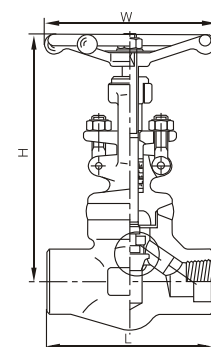

Class900 ~ 1500 Main Outline Dimensions & Weight

Bold fastening valve cover, outside screw stem & yoke (OS&Y).
Designs according to BS5,352.

R.P	-	1/2	3/4	1	1 1/4	1 1/2	2	2 1/2
F.P	1/4	3/8	1/2	3/4	1	1 1/4	1 1/2	2
L	92	111	111	120	152	172	200	220
W	100	125	125	160	160	180	200	240
H	171	207	207	240	258	330	355	370
d	7	12	15	20	28	32	40	45
Weight(kg)	2.3	3.7	3.6	6.8	7.6	11.6	15	21.9

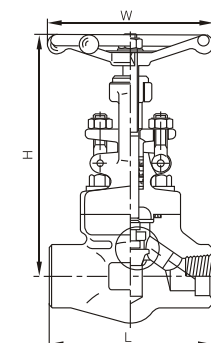

Class900 ~ 1500 Main Outline Dimensions & Weight

Weld joint valve cover, outside screw stem & yoke (OS&Y).
Designs according to BS5,352.

R.P	-	1/2	3/4	1	1 1/4	1 1/2	2	2 1/2
F.P	1/4	3/8	1/2	3/4	1	1 1/4	1 1/2	2
L	92	111	111	120	152	172	200	220
W	100	125	125	160	160	180	200	240
H	171	207	207	240	258	330	355	370
d	7	12	15	20	28	32	40	45
Weight(kg)	2.0	3.4	3.3	6.0	5.6	10.3	14.2	18.5

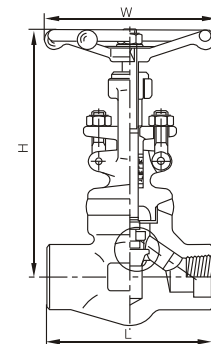

Y-Type Forged Steel Globe Valve

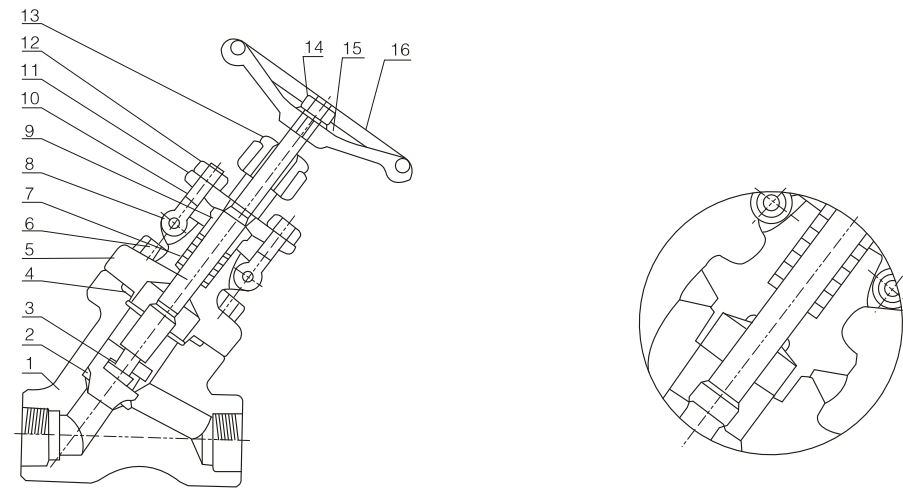

Technical Specification

Steel Globe Valves, API 602
 Steel Valves, ASME B16.34
 Face to Face, Manufacturer Standard
 Face to Face, Flanged, ASME B16.10
 End Flanges, ASME B16.5
 Buttwelding Ends, ASME B16.25
 Socket-welding Ends, ASME B16.11
 Screwed Ends, ASME B1.20.1
 Inspection and Test, API 598

Design Description

Outside Screw and Yoke (OS&Y)
 Bolted Bonnet
 Choice of WB, Welding Bonnet
 Loose Disc, Choice of Plug or Ball
 Seat Rings Integral with Body
 Yoke Integral with Bonnet
 Rising Stem and Handwheel
 Horizontal Service
 SW, Socket-welding Ends
 SC, Screwed Ends
 BW, Buttwelding Ends

Form of Major Part Material

No.	Components name	A105 F6a	A105 F6aHFS	LF2 304	F11 F6aHF	F304(L) 304(L)	F316(L) 316(L)	F91 410HF
1	Body	A105	A105+HF	LF2	F11+HF	F304(L)	F316(L)	F51
2	Disc	F6a	F6a	F304	F6aHF	F304(L)	F316(L)	F51
3	Stem	410	410	304	410	304(L)	316(L)	F51
4	Gasket	304+Corrugated SS+Graphite						
5	Bonnet	A105	A105	LF2	F11	F304(L)	F316(L)	F51
6	Bolt	B7	B7	F7	B16	B8(M)	B8(M)	B8M
7	Pin	410	410	410	410	304	304	304
8	Gland	410	410	304	410	304	316	F51
9	Gland Eyebolt	B7	B7	L7	B16	B8(M)	B8(M)	B8M
10	Gland	A105	A105	LF2	F11	F304	F304	F304
11	Gland nut	2H	2H	2H	2H	8(M)	8(M)	BM
12	Yoke Nut	410	410	410	410	410	410	410
13	Locks the nut	35	35	35	35	35	35	35
14	Name plate	AL	AL	AL	AL	AL	AL	AL
15	Handwheel	A197	A197	A197	A197	A197	A197	A197

Y-Type Forged Steel Globe Valve

Class800 Main Outline Dimensions & Weight

Bolt fastening valve cover, outside screw stem & yoke (OS&Y).
 Designs according to BS5,352.

R.P	-	1/2	3/4	1	1 1/4	1 1/2	2	2 1/2
F.P	1/4	3/8	1/2	3/4	1	1 1/4	1 1/2	2
L	98	98	98	111	140	140	155	170
W	100	100	100	125	160	160	180	200
H	180	180	180	188	280	280	295	350
d	7	9	13	17.5	23	30	35	46
Weight(kg)	2.6	2.6	3.8	4.6	9.3	9.3	14	19.6

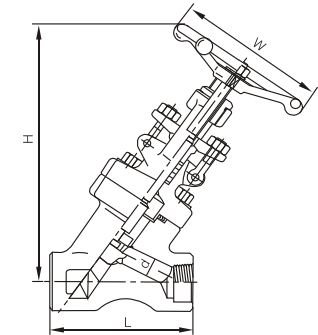

Class800 Main Outline Dimensions & Weight

Weld joint valve cover, outside screw stem & yoke (OS&Y).
 Designs according to BS5,352.

R.P	-	1/2	3/4	1	1 1/4	1 1/2	2	2 1/2
F.P	1/4	3/8	1/2	3/4	1	1 1/4	1 1/2	2
L	79	79	92	100	140	140	155	170
W	100	100	100	125	160	160	180	200
H	198	198	198	207	80	280	295	350
d	7	9	13	17.5	23	30	35	46
Weight(kg)	1.8	1.8	2.0	3.5	8.0	8.0	12	16

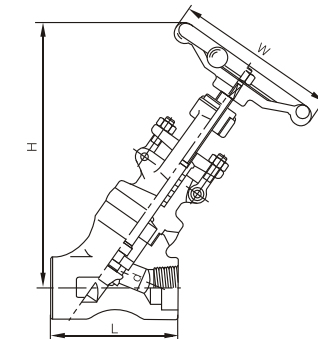

Class900 ~ 1500 Main Outline Dimensions & Weight

Bolt fastening valve cover, outside screw stem & yoke (OS&Y).
 Designs according to BS5,352.

F.P	3/8	1/2	3/4	1	1 1/4	1 1/2	2
L	98	111	111	140	140	155	170
W	100	125	125	160	160	180	200
H	175	175	215	216	254	305	350
d	9	12	15	20	28	32	40
Weight(kg)	2.6	4.6	4.6	9.3	9.3	14	19.6

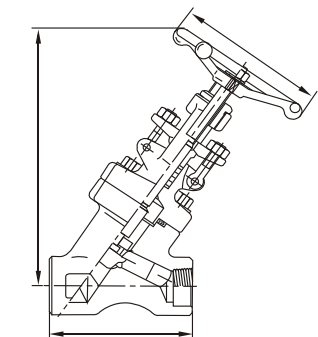

Y-Type Forged Steel Globe Valve

Class900 ~ 1500 Main Outline Dimensions & Weight

Weld joint valve cover, outside screw stem & yoke (OS&Y).
Designs according to BS5,352.

F.P	3/8	1/2	3/4	1	1 1/4	1 1/2	2
L	92	100	100	140	140	155	170
W	100	125	125	160	160	180	200
H	175	207	207	280	280	295	350
d	9	12	15	20	28	32	40
Weight(kg)	1.8	3.5	3.5	8.0	8.0	12	16

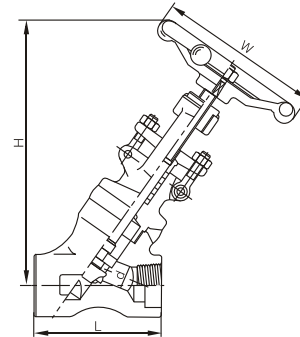

Class2500 Main Outline Dimensions & Weight

Weld joint valve cover, outside screw stem & yoke (OS&Y).
Designs according to BS16.34

F.P	3/8	1/2	3/4	1	1 1/4	1 1/2	2
L	186	186	186	186	232	232	310
W	200	200	200	200	280	280	300
H	329	329	329	329	350	350	383
d	9	11	14	19	25	28	35
Weight(kg)	12.3	12.3	11.6	10.8	28.0	26.4	43.8

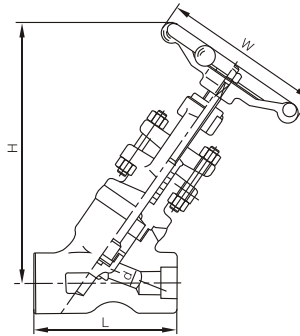

Class2500 Main Outline Dimensions & Weight

Pressure seal bonnet, outside screw stem & yoke (OS&Y).
Designs according to BS16.34

F.P	3/8	1/2	3/4	1	1 1/4	1 1/2	2
L	186	186	186	186	232	232	310
W	200	200	200	200	280	280	300
H	333	333	333	333	406	406	383
d	9	11	14	19	25	28	35
Weight(kg)	12.3	12.3	11.6	10.8	28.0	26.4	43.8

